

Mills Lane and Swanson Street

Public engagement on preliminary design for street improvements - May 2024

Auckland Council - City Centre team

[ProgressAKL.co.nz/swansonandmills](https://progressakl.co.nz/swansonandmills)



MILLS LANE AND SWANSON STREET IMPROVEMENTS

PRELIMINARY DESIGN

Introduction

Auckland Council is progressing improvements to Mills Lane and Swanson Street. We want to make these laneways more pleasant and safer places for everyone to move around in.

These laneways are already well-used with around three thousand pedestrians using the laneways as a link between Albert Street and Queen Street each day. This use will increase as new tenants move into nearby private developments and buses return to Albert Street.

The laneways, especially Mills Lane, play an important role in servicing needs for vehicles such as trucks unloading goods. We want to make them work better for people accessing properties and businesses, including for people loading and unloading goods.

We're currently in the design phase of the project. This includes a public consultation period and engagement with local residents, businesses and people moving through the area.

Developing the design

A 2021 study of the project area identified the following issues:

- An unattractive walking environment, including poor connectivity.
- Unsafe laneway environment for pedestrians.
- Deficient vehicle loading and servicing provisions creating non-compliance with traffic and parking rules.
- A degraded streetscape environment in Mills Lane.

In 2022, we spoke with people who own property, live and/or work in the area, their input helped us to develop initial plans and we have recently spoken to property owners, property managers and businesses who use the lanes.

We are now engaging with the wider community, including residents and those who use the lanes to further develop the design.

Have your say

Public consultation is open until 4 June 2024. We hope you will give us feedback to help us finalise the design.

Provide your **feedback online** by scanning the QR code below or by visiting ProgressAKL.co.nz/swansonandmills

You can also talk to us during one of our **public drop-in sessions**:

- **IN PERSON** 22 May 2024, 10-4 pm at Swansons Sandwich Bar
- **ONLINE** 23 May 2024, 6 - 7 pm (on Zoom)

Register for the online session at: ProgressAKL.co.nz/swansonandmills

Email the project team at citycentre@aucklandcouncil.govt.nz

Scan here to learn more about the project and have your say.



PROPOSED DESIGN FEATURES FOR MILLS LANE AND SWANSON STREET

Our design proposes the following changes:

A shared space environment

To make the area more pedestrian-friendly, we are proposing a shared space environment at the intersection of Swanson Street and Mills Lane. The shared space will be similar to other shared environments in the city centre such as Galway Street west and Federal Street south.

- A shared space removes distinctions between the road and the footpath; people on foot, bikes, scooters and in vehicles use the same space.
- While no particular road user has priority over the other, motorists must give way to pedestrians and cyclists.
- The street in the area of the Swanson Street and Mills Lane intersection is proposed to be level from building to building (also called flush) without a grade-separated footpath.
- A shared space environment is designed for low vehicle speeds of 10 km/h.

A lower speed limit

Other city centre shared spaces have a 10km per hour speed limit and so to improve safety and accessibility, we are proposing a lower speed limit of 10 km per hour within the shared space zone and for the southern section of Mills Lane from Swanson Street.

The speed limit on Mills Lane and Swanson Street is currently 30km per hour.

A safer and more accessible crossing point

We're proposing footpath widening and a new pedestrian crossing on Mills Lane in line with the Exchange Lane staircase, an obvious crossing point for pedestrians.

- A raised zebra crossing would provide a safer and more accessible crossing point, further slowing vehicles.
- It will create a continuous walking journey for people walking to and from the pedestrianised section of Exchange Lane.

Servicing, loading and parking

Mills Lane is well-used by people loading and unloading goods, so we're planning to provide more vehicle servicing opportunities.

- We are proposing three additional loading zones on Mills Lane, north of Swanson Street.
- We want to increase the time you can park in loading zones from P5 to P15. Proposed changes to the time allowed to park in loading zone time will support flexibility of use.
- A new loading space for servicing the supermarket is proposed on southern Mills Lane.



Greening initiatives

We are exploring replacing the current bollards installed in the footpath with planter boxes to bring some greenery into the laneways.

Improved footpaths and better walking environment

Wider footpaths and improvements including:

Widening the southern footpath on Swanson Street and widening the eastern side of Mills Lane from 1.5m to 1.8m.

Better street lighting

We are planning to improve lighting in the project area. This will help improve pedestrian safety, people's sense of personal safety and encourage more people to use the laneways in the evening.

- Lighting in the shared space area will be upgraded to meet current design standards.
- Overall lighting levels will increase and be more consistent across the space.

There will be upgrades to the current streetlights and additional lighting will be provided along Mills Lane South.

Improved road safety

The width of the road will be slightly reduced in some places on Mills Lane. A narrower road helps slow traffic and makes the area safer for everyone.

- All driveway access will be maintained.
- Fire and emergency vehicles will have enough space to move around.

PARTNERING WITH MANA WHENUA

Our mana whenua partners for the project are Ngāti Whātua Ōrākei and Ngāti Maru. We are learning more about the significance of the project area and working to incorporate Māori outcomes into the project.

We'll provide updates about this aspect of the work as the project progresses.



WHAT MIGHT THE IMPROVEMENTS LOOK LIKE?

Our preliminary design

The next few pages show our preliminary design and a few artist impressions of what the laneways could look like.

We will review all the feedback we receive about the proposed design features to see if any changes to our proposal are required.

We will then develop an updated design and seek the necessary permissions and consents to begin construction.

Construction

At this stage, we're aiming to begin construction in early 2025. We'll share more updates about the construction programme as it is developed.

We are committed to managing the impacts of construction on people who live, work and travel through the area.

Have your say

Public consultation is open until 4 June 2024. We hope you will give us feedback to help us finalise the design.

Provide your **feedback online** by scanning the QR code below or by visiting ProgressAKL.co.nz/swansonandmills

You can also talk to us during one of our **public drop-in sessions**:

- **IN PERSON** 22 May 2024, 10-4 pm at Swansons Sandwich Bar
- **ONLINE** 23 May 2024, 6 - 7 pm (on Zoom)

Register for the online session at: ProgressAKL.co.nz/swansonandmills

Email the project team at citycentre@aucklandcouncil.govt.nz

Scan here to learn more about the project and have your say.



Page 5



PRELIMINARY DESIGN - May 2024

Proposed overall plan

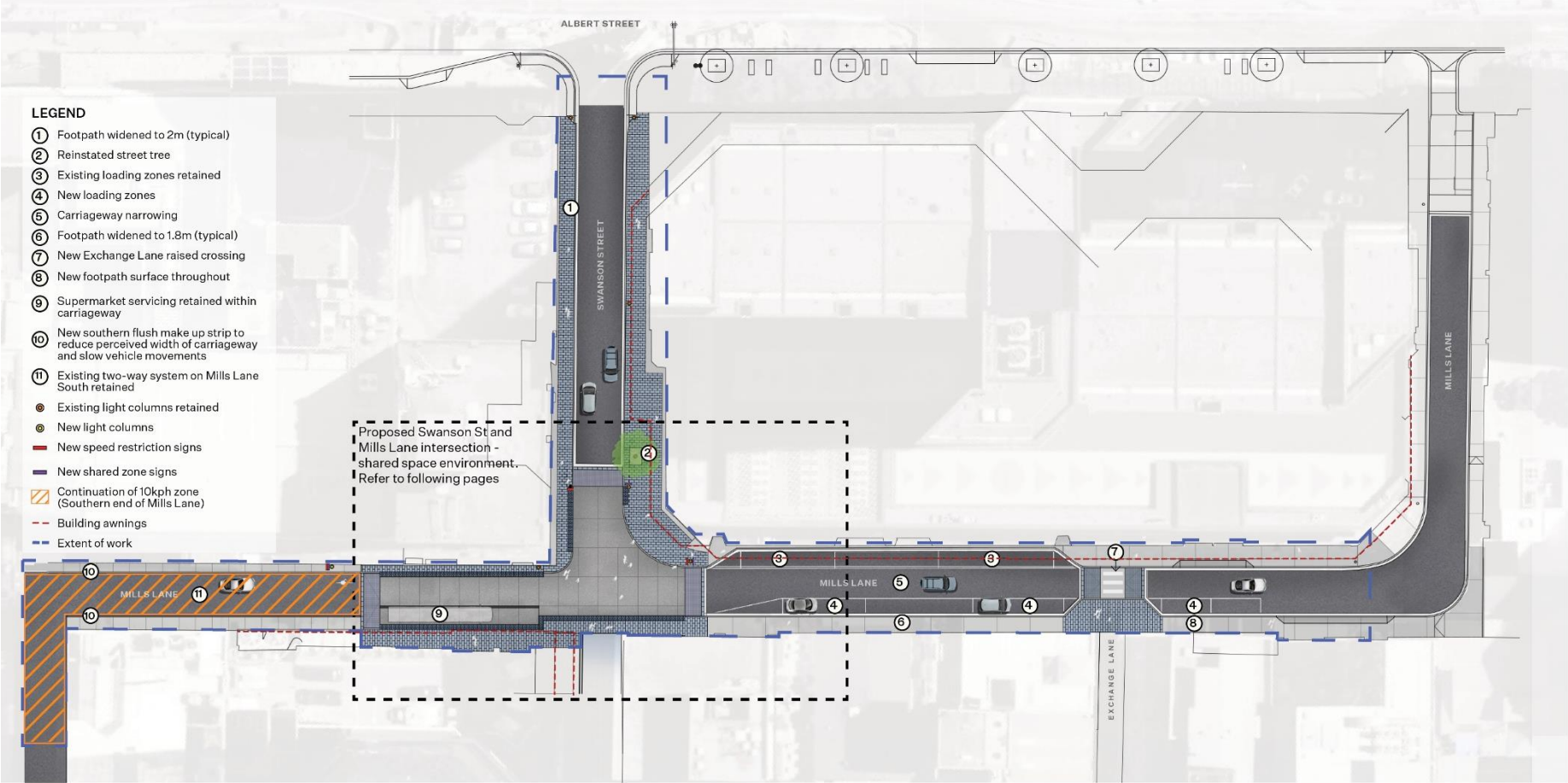

PRELIMINARY DESIGN - May 2024

Detail plan - new shared space environment

LEGEND

- ① Footpath widened to 2m (typical)
- ② Reinstated street tree
- ③ Existing loading zones retained
- ④ New loading zones
- ⑤ Carriageway narrowing
- ⑥ Footpath widened to 1.8m (typical)
- ⑦ New Exchange Lane raised crossing
- ⑧ New footpath surface throughout
- ⑨ Supermarket servicing retained within carriageway
- ⑩ New southern flush make up strip to reduce perceived width of carriageway and slow vehicle movements
- ⑪ Existing two-way system on Mills Lane South retained
- Existing light columns retained
- New light columns
- New speed restriction signs
- New shared zone signs
- ▨ Continuation of 10kph zone (Southern end of Mills Lane)
- - - Building awnings
- - - Extent of work

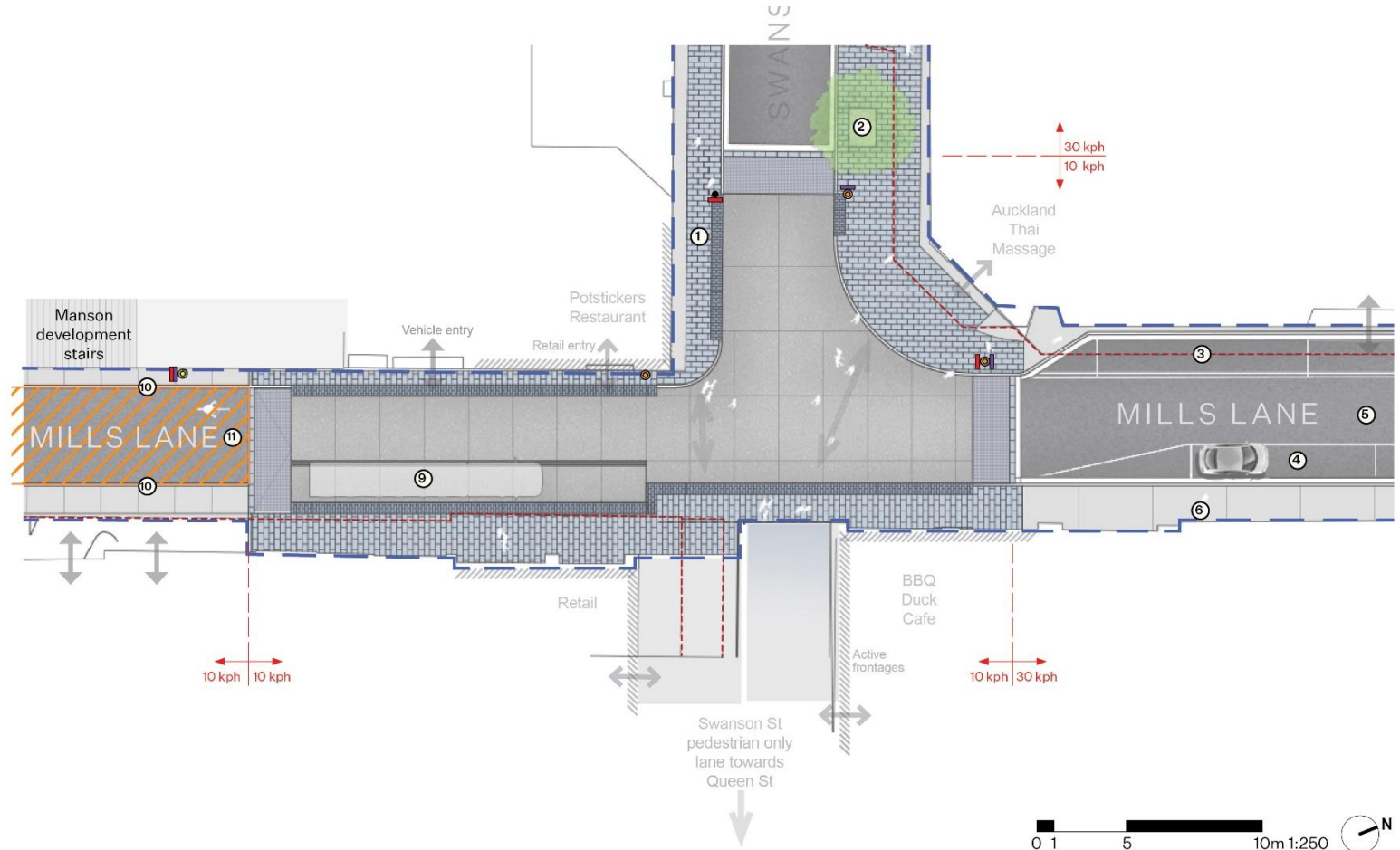

PRELIMINARY DESIGN - May 2024

Artist's impressions



VIEW 1
Swanson St and Mills Lane intersection – shared space
Looking East

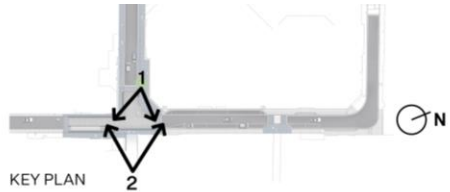

VIEW 2
Swanson St and Mills Lane intersection – shared space
Looking West



PRELIMINARY DESIGN - May 2024

Artist's impressions



VIEW 3
Southern end of Mills Lane
Looking North toward Swanson St and Mills Lane intersection

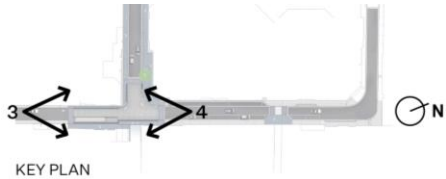

VIEW 4
Northern side of Mills Lane
Looking South toward Swanson St and Mills Lane intersection

